

## TSSC-A03 1.000-5.000 (inches) Cartridge Seal

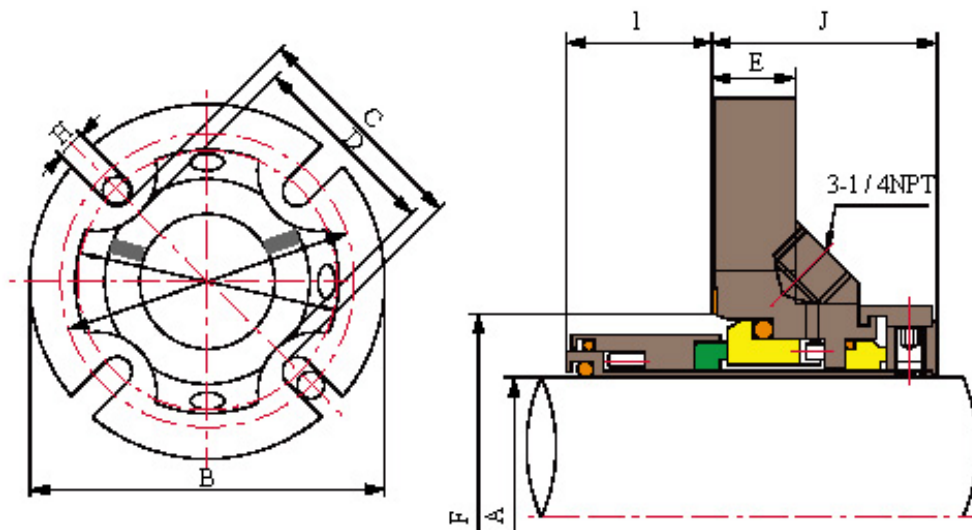

### Operating Limits

Pressure:  $\leq 2.3\text{MPa}$

Speed:  $\leq 16\text{m/s}$

Temperature:  $-30^{\circ}\text{C} \sim 200^{\circ}\text{C}$

Rotary Ring (Carbon/SiC/TC)

---

**Shanghai Trisun Parts Manufacture Co.,Ltd.**

**Head office in Shanghai:**

Room 05-06, 16th Floor, Hongjia Building, No.388 Fushan Rd. (Near Xiangcheng Rd.), Pudong, Shanghai, China.

**Post Code:** 200122

**Tel:** +86-21-58355541,+86-21-58353145,+86-21-58353343

**Fax:** +86-21-58353141

**E-mail:** [trisunseal@yahoo.com.cn](mailto:trisunseal@yahoo.com.cn)



Stationary Ring (SiC/TC)  
 Secondary Seal (VITON/EPDM/Kalrez)  
 Other Parts (SUS304/SUS316)

A (mm)	B	C	D	E	F		G		H max	I	J
					min	max	min	max			
24	104.8	54	49.2	13.2	40	46	67	90.5	12	28.6	40.5
25	104.8	54	49.2	13.2	41	49	67	90.5	12	28.6	40.5
28	108	57.2	52.4	13.2	44	52.3	70.3	93.6	12	28.6	40.5
30	111	60.4	55.6	13.2	46	55.5	73.5	96.8	12	28.6	40.5
32	111	60.4	55.6	13.2	48	55.5	73.5	96.8	12	28.6	40.5
33	111	60.4	55.6	13.2	49	55.5	73.5	96.8	12	28.6	40.5
35	111	63.5	58.8	13.2	51	57.5	76.6	96.8	12	28.6	40.5
38	127	71.5	65	16.4	57.2	60.4	85.7	114.3	12	28.6	44.5
40	127	71.5	65	16.4	58	60.4	85.7	114.3	12	28.6	44.5
43	139.7	81	71.4	16.4	61	69.9	95.3	127	12	28.6	44.5
45	139.7	81	71.4	16.4	63.5	69.9	95.3	127	12	28.6	44.5
48	139.7	81	71.4	16.4	66.7	73	95.3	127	12	28.6	44.5
50	152.4	90.5	77.8	16.4	68	76.2	104.8	139.7	12	28.6	44.5
53	152.4	90.5	77.8	16.4	71	76.2	104.8	139.7	12	28.6	44.5
55	165.1	96.8	84.1	16.4	74	82.5	114.3	149.2	16	28.6	44.5
58	165.1	96.8	84.1	16.4	76.2	82.6	114.3	149.2	16	28.6	44.5
60	165.1	96.8	84.1	16.4	79.4	85.7	114.3	149.2	16	28.6	44.5
63	177.8	109.5	96.8	19.6	85.8	92.1	127	160.3	16	31.8	47.7
65	177.8	109.5	96.8	19.6	88.9	95.3	127	160.3	16	31.8	47.7
68	177.8	109.5	96.8	19.6	92.1	98.4	127	160.3	16	31.8	47.7
70	177.8	109.5	96.8	19.6	92.1	98.4	127	160.3	16	31.8	47.7
75	190.5	125.4	108	19.6	98.5	108	142.9	173	16	31.8	47.7
80	190.5	125.4	108	19.6	101.6	111.1	142.9	173	16	31.8	47.7
85	203.2	135	117.5	19.6	108	117.5	155.6	182.5	20	31.8	47.7
90	215.9	150.8	127	19.6	114.3	127	171.5	195.2	20	31.8	47.7
95	215.9	150.8	127	19.6	117.5	130.2	171.5	195.2	20	31.8	47.7
100	228.6	168.3	136.5	19.6	123.9	139.7	188.9	207.9	20	31.8	47.7
105	228.6	168.3	136.5	19.6	130.1	149.2	189	208	20	31.8	47.7
110	241.3	177.8	146.1	19.6	136.5	158.8	198.4	220.6	20	31.8	47.7
115	254	186.6	155.6	19.6	142.9	168.3	211.1	230.2	22	31.8	47.7
120	254	186.6	155.6	19.6	142.9	168.3	211.1	230.2	22	31.8	47.7
125	254	186.6	155.6	19.6	149.2	168.3	211.1	230.2	22	31.8	47.7

**Shanghai Trisun Parts Manufacture Co.,Ltd.**

**Head office in Shanghai:**

Room 05-06, 16th Floor, Hongjia Building, No.388 Fushan Rd. (Near Xiangcheng Rd.), Pudong, Shanghai, China.

**Post Code:** 200122

**Tel:** +86-21-58355541,+86-21-58353145,+86-21-58353343

**Fax:** +86-21-58353141

**E-mail:** [trisunseal@yahoo.com.cn](mailto:trisunseal@yahoo.com.cn)



---

**Shanghai Trisun Parts Manufacture Co.,Ltd.**

**Head office in Shanghai:**

Room 05-06, 16th Floor, Hongjia Building, No.388 Fushan Rd. (Near Xiangcheng Rd.), Pudong, Shanghai, China.

**Post Code:** 200122

**Tel:** +86-21-58355541,+86-21-58353145,+86-21-58353343

**Fax:** +86-21-58353141

**E-mail:** [trisunseal@yahoo.com.cn](mailto:trisunseal@yahoo.com.cn)